

## MMTS cart's with new Elmo TT-12 Document Camera!

Because we chose to continue with the Elmo, the outside appearance of the new TT-12 should be familiar. But that is all that is the same.

There are plenty of new features that the manual (link below) describe in detail. Several observations from our deployment team may help you with initial use of the camera:

- In order to make use of the high definition images from the camera, we have changed the way the cables allow for projection of the document camera and computer. Now, you choose to project either the Elmo or the Computer on the Epson projector. You can use the "Source" button on the remote for quick access to either device. You no longer control computer or document camera from the document camera controls. See diagram below.
- If you hear a loud obnoxious sound when you switch to the document camera, turn down the volume on the Epson Projector. With external speakers connected, the volume on the projector can create a vicious feedback loop.
- The document cameras were connected to your computer and the Image Mate software will be installed during the setup process, so you can control document camera features and record images and movies directly from the camera on your desktop computer!
- *Note If you attempt to record movies with this document camera, both audio and video will record successfully to a USB flash drive or SD Card plugged directly into the camera. The audio is being recorded on the USB drive utilizing the built in microphone. When using the Image Mate software and the computer to record the video you need to connect the audio output on the TT-12 to the microphone jack on the computer to get audio utilizing the camera's built in microphone. We have a limited supply of these cables, but they can be purchased at any Best Buy or Radio Shack.*

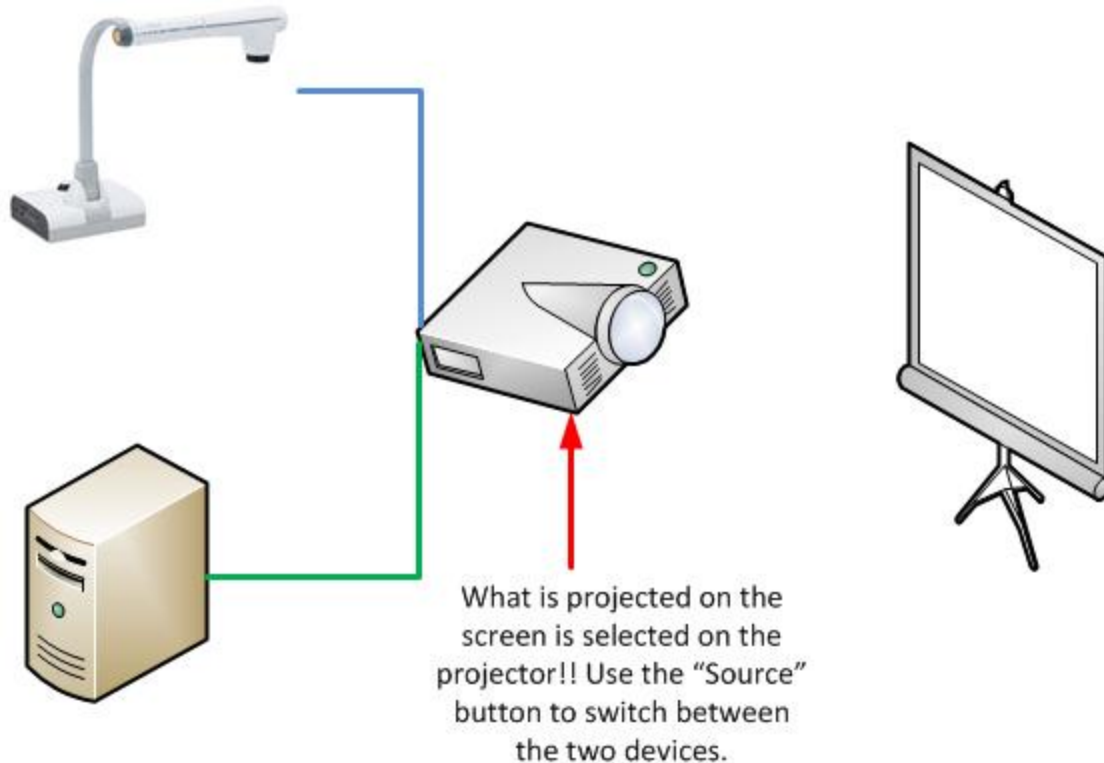

Recently, your MMTS carts received new Elmo TT-12 Document Cameras! In my earlier email, I explained some of the differences that may cause initial issues with using the camera. If you still experience startup problems, please let me or the Help Desk know.

The most significant change is the ability to control and record images from your desktop computer. Classroom demonstrations can be saved as still JPEG or MP4 video files and then posted on your classroom website for later viewing. The video files that I have seen recorded were very smooth, given their frame rate of 30 frames per second.

I included the links to the online manual in yesterday's email (they are included below as well). But if you are not a big "manual reader", the 5-part video series that I found on You Tube may be better to your liking. The series gives an overview of the basic operations of the Elmo TT-12. They are short (3-5 minutes) and are very helpful! A teacher who viewed these videos shared the following testimonial, "[I have watched the videos and they helped soooo much.](#)" Give them a shot yourself and see if you agree! Enjoy!

Scott Jenkins and the IS Tech Team

---

Here are links to the quick training guide and manual for the camera.

- Elmo Quick Training Guide  
(<http://www.elmoussa.com/sites/default/files/Quick%20Training%20Guide%20TT-12.pdf>)

- Elmo Instruction Manual ([http://www.elmoussa.com/sites/default/files/L-12\\_TT-12.pdf](http://www.elmoussa.com/sites/default/files/L-12_TT-12.pdf))

#### Introduction to the Elmo TT-12

- Training Video #1: Setup of Your Elmo TT-12  
(<http://www.youtube.com/watch?v=cTnLwVdSu3c&list>)
- Training Video #2: Basics Of Your Elmo TT-12  
(<http://www.youtube.com/watch?v=8txca0hqbJc&list>)
- Training Video #3: The Remote To Your Elmo TT-12  
(<http://www.youtube.com/watch?v=sqpcogyRJPI&list>)
- Training Video #4: Operational Panel of Your Elmo TT-12  
(<http://www.youtube.com/watch?v=H3j9HtwpITQ&list>)
- Training Video #5: Image Mate software For Your Elmo TT-12  
(<http://www.youtube.com/watch?v=6MktsRlvju8&list>)